

# MS6D 6LED+6LED DUAL COLOUR LIGHTHEAD

## Surface Mount

To Chassis Ground:.....**BLACK**

To+VDC for **COLOUR 1** (fuse @ 2A):.....**RED**

To+VDC for **COLOUR 2** (fuse @ 2A):.....**WHITE**

(To+VDC for **COLOUR 1 2** alternating:..**RED+WHITE**)

For Synchronization and  
Flash Pattern:.....**YELLOW**

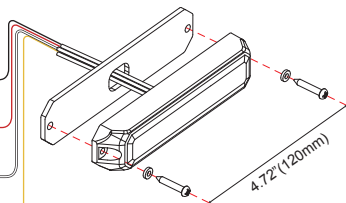

For Synchronization:

Connect **YELLOW** wires of all heads together for synchronization  
(All heads should be set at the same Flash Pattern)

For Simultaneous or Alternating Flash:

- Apply +VDC to **RED** (or **WHITE**) and **YELLOW** wires simultaneously to enter Grouping mode; lighthead will display short (single or double) flashes:
  - Single flash = Group1    • Double flash = Group2
- Remove **YELLOW** wire from +VDC and momentarily apply to +VDC to change Groups:
  - Heads in the same Group flash together.
  - Group1 Heads alternate with Group2 heads.

For Flash Pattern, momentarily apply

+VDC to **YELLOW** wire:

- once for next pattern
- quickly three times for reset to FP#1  
(see flash pattern chart)

**NOTE:** This unit may not be factory-set  
at Flash Pattern #1

Flash Patterns

1	Random	7	Quad (SAE)
2	Steady	8	Quint (SAE)
3	Single (SAE)	9	8-Flash (SAE)
4	Mega	10	Single-Quad
5	Double (SAE)	11	Single H/L
6	Triple (SAE)	12	Singe-Triple-Quint