

OCULUX® MEDIUM DUTY PIVOT MOUNT



Medium Duty Pivot Camera Mount complete with Oculux® Wide, 1080p, AHD CCTV Camera

PART NUMBER: 301258-C

OVERVIEW

The Medium Duty Pivot Camera Mount is designed for use in locations where the camera may need protection from light bumps and scrapes. Manufactured from 1.5mm corrosion resistant stainless steel, this bracket can be mounted in a variety of orientations to suit the location.

The pivot mechanism allows the angle of the camera to be adjusted for optimum field of view.

This unit comes equipped with a high-performance Oculux® 1080p wide-angle AHD CCTV camera.

OCULUX® CAMERA

The Oculux® camera is supplied with a high performance nylon polyamide (Eplamid) shell that offers exceptional strength and resilience in all conditions.

Oculux® is the only vehicle CCTV camera designed specifically for the challenges of commercial, heavy goods vehicle and emergency service vehicle use.

Key features

- Tested to the highest vibration, impact, resistance, corrosion and submersion criteria
- Injection moulded, anti-shock and life-time guaranteed casings
- Very high quality low light vehicle CCTV image reproduction technology
- Advanced water repellent, anti-reflection and ultra tough anti-abrasion coatings
- Over 2.1 million pixels and 1080P HD at 19:8 aspect ratio – more than double standard vehicle CCTV density
- Conforms to the highest ingress protection (IP) ratings of IP68 and IP69K
- Every camera has to pass a thorough operational readiness test
- Designed and manufactured in the UK



**MADE IN
BRITAIN**

Dimensions

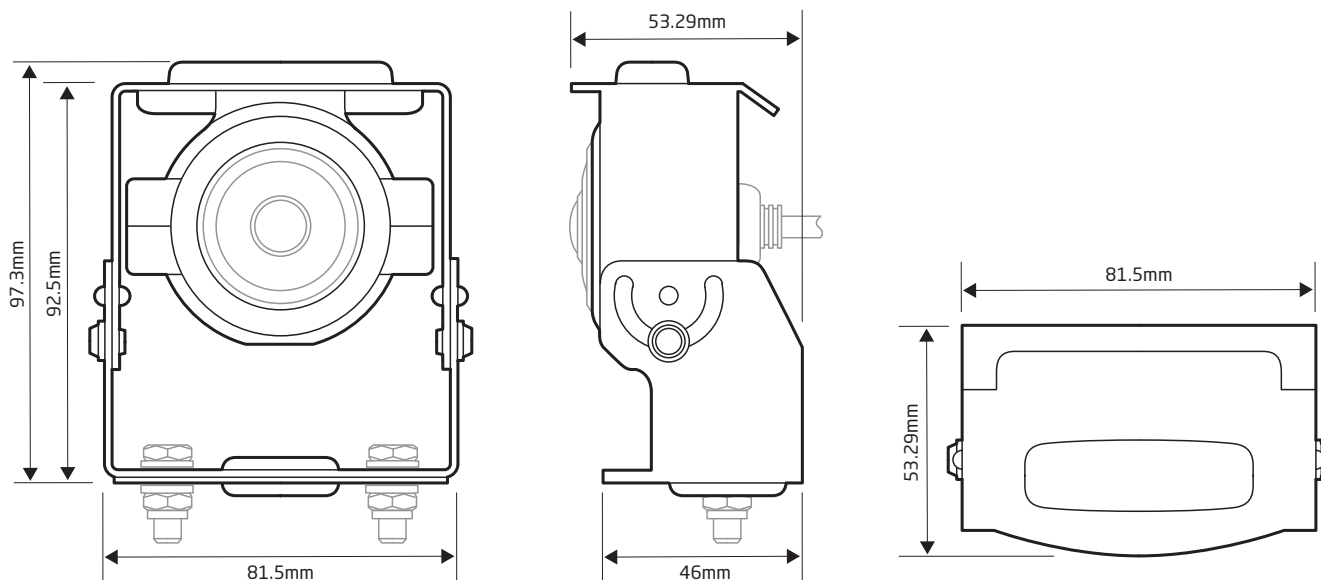

Camera Specification

Oculux® Camera	Model: 301258
Imaging Technology	UltraLux+ - Advanced low light CPU technology
Lens Technology	HyperLens - anti-abrasion and anti-reflective technology
Horizontal Field of View	Wide (159°)
Resolution	HD2: 1920 x 1080
Transmission	AHD
Format	PAL
Enclosure	Shell: High performance nylon polyamide (Eplamid) Illumination Cover: Thin film optical coated automotive grade polycarbonate
Connector	4-pin Aero style
Cable	PVC 0.5cm shielded
Dimensions	48mm diameter
Ingress Protection	IP68 / IP69K
Current Consumption	HD2 PAL @ 12Vdc: 80mA to 140mA
Operating Temperature	-40°C to +70°C (ambient)
Storage Temperature	-40°C to +90°C (ambient)
Certification	ECE-R10-05: E11*10r05 / 01*10998*04 FCC: G6413TC1
Warranty	2 years standard, 5 years standard corrosion and mount failure

Installation Notes

The pedestal mount and camera are supplied fully assembled however there are a few notes to mention prior to installation:

- The dot at the centre of the camera shell should always be at the top. This indicates the correct orientation of the camera view. Please ensure you specify the orientation of the bracket prior to placing your order
- The cable should not have any extreme bends that could cause damage to the wiring within



Camera Connection

Cable specification

- 4-Core
- Copper wire
- OD = 5.0mm Black PVC
- 4-Core + Video Shield + Overall Plastic Foil Wrap
- Power: RED
- Video: YELLOW with SHIELD (GND)
- Audio: WHITE
- GND: BLACK
- Overall Plastic Foil Wrap

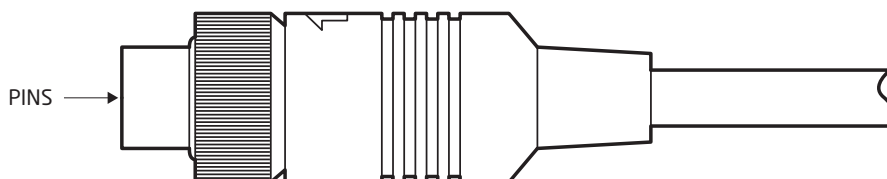
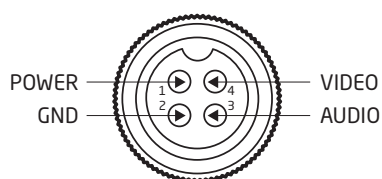
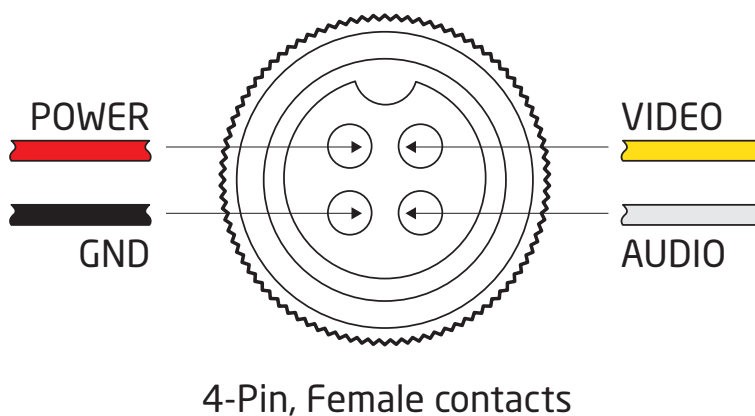

Additional Mounting Options - supplied complete with camera



AEROCAM

Available in Black, White and Yellow



PEDESTAL MOUNT

Available 100mm as standard



GLASS MOUNT

Self-adhesive, adjustable